

Refurbishment strategy

Brussels Capital Region

Brussels, October 2015

Aurore BRUNSON

Dept. Air, Climate and Energy

Brussels Environment



BRUXELLES ENVIRONNEMENT

IBGE - INSTITUT BRUXELLOIS POUR LA GESTION DE L'ENVIRONNEMENT

BRUSSELS SITUATION

- 162 km²
- 1,1 million expected +
- 630.000 v
- Old buildi
- 75% of er
- Very low r
- Large reg
mobility, urbanism, housing, ...

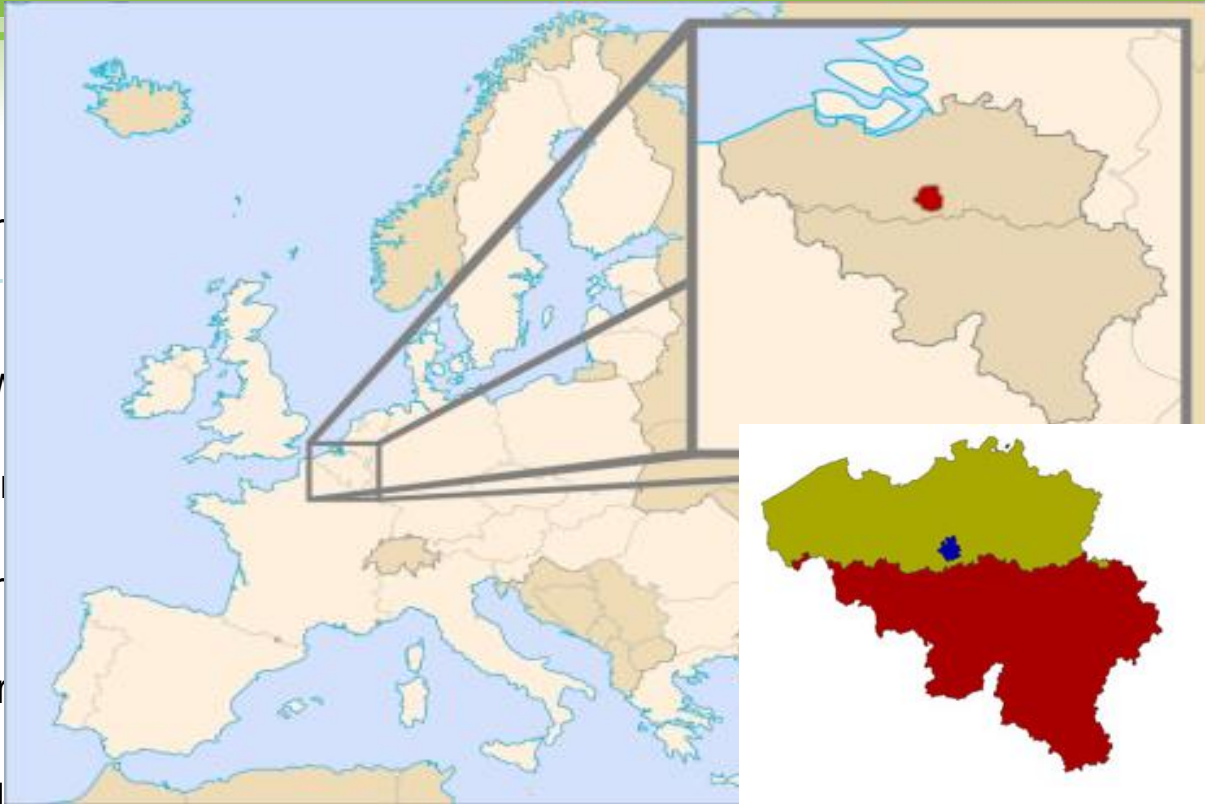

BRUSSELS CONTEXT : BUILDING STOCK PARTICULARITIES

Type

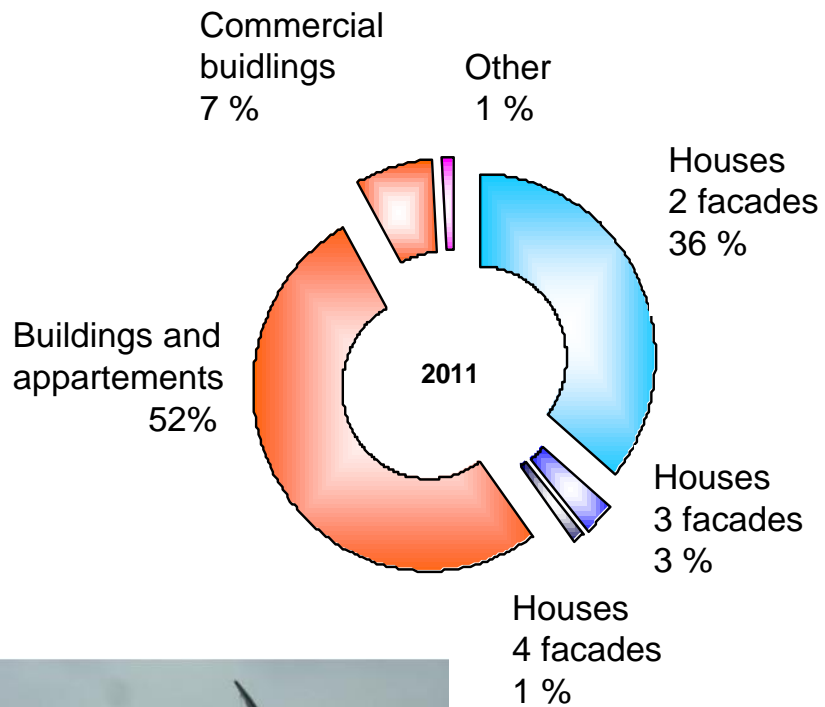

Age

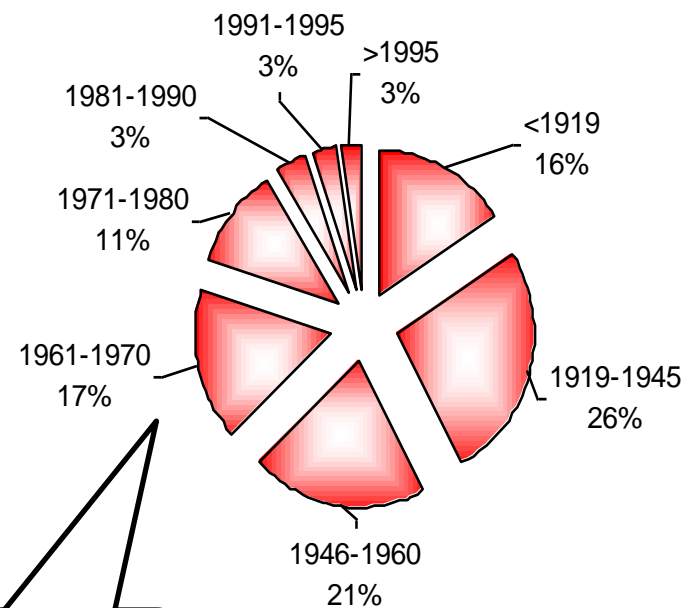

Mostly build
between 1919
and 1970



BRUSSELS CONTEXT : BUILDING STOCK PARTICULARITIES

% Owner – tenant

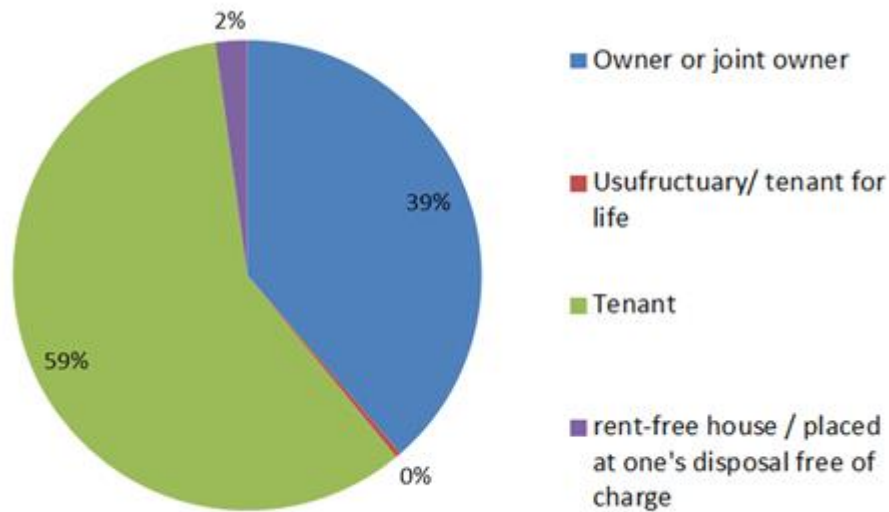

BRUSSELS CONTEXT: ENERGY CONSUMPTION

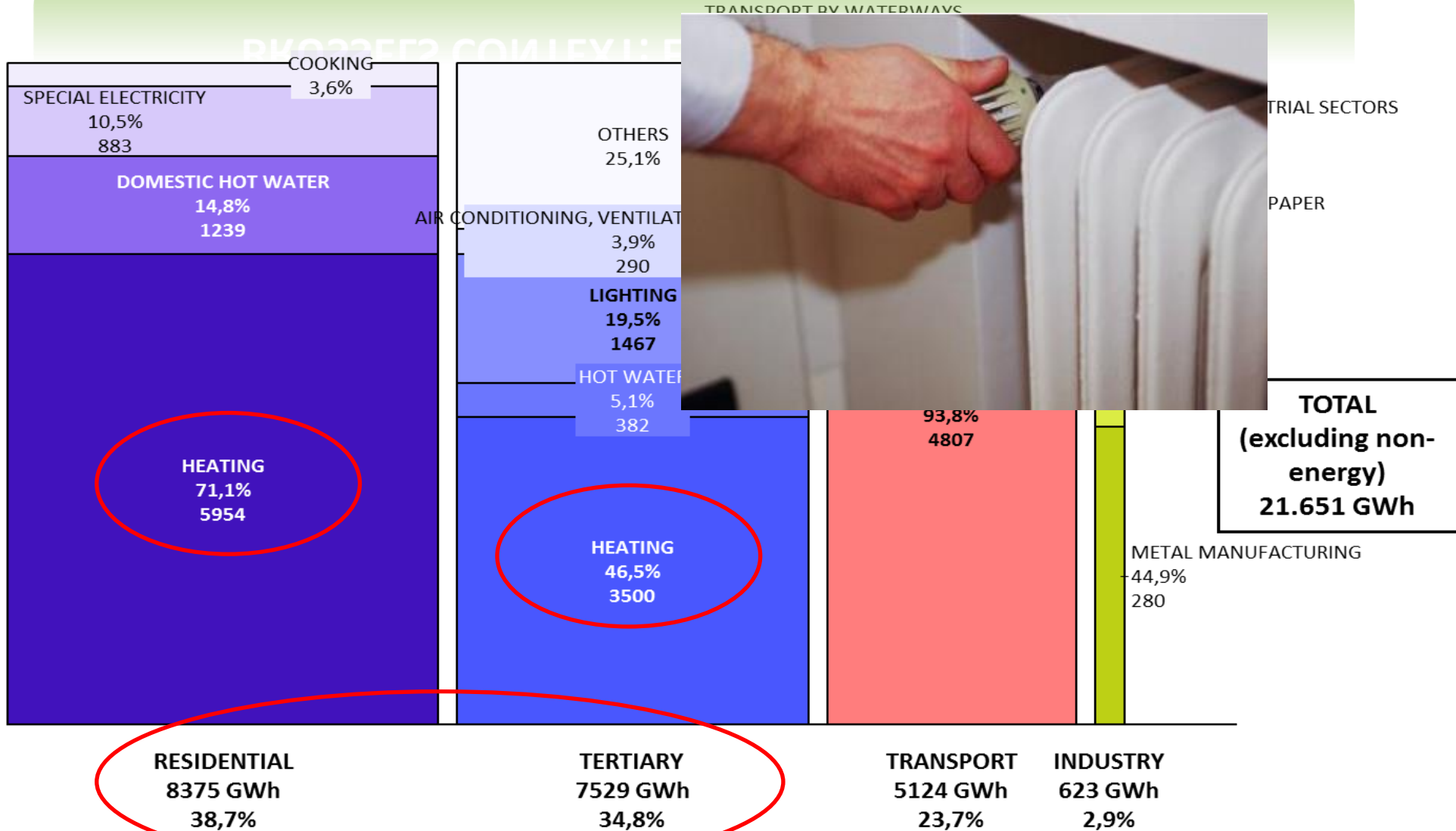

Data source: 2012 Energy assessment of the BCR – Brussels Environment

COST-EFFECTIVE APPROACH FOR BUILDING REFURBISHMENT

Types of buildings studied : houses, apartments and offices
Analyse of architectural and technical alternatives

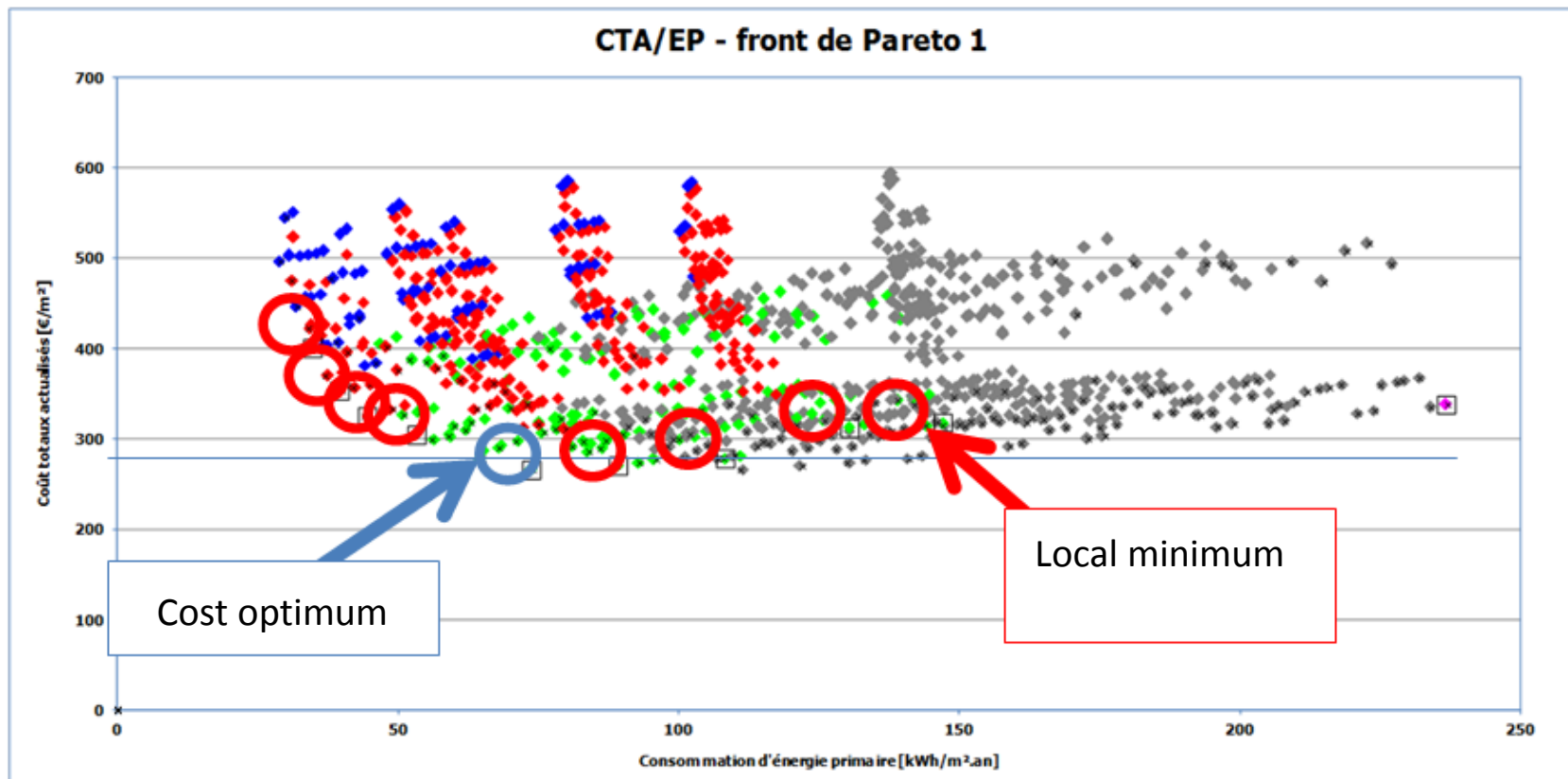

COST-EFFECTIVE APPROACH FOR BUILDING REFURBISHMENT

Potential energy savings

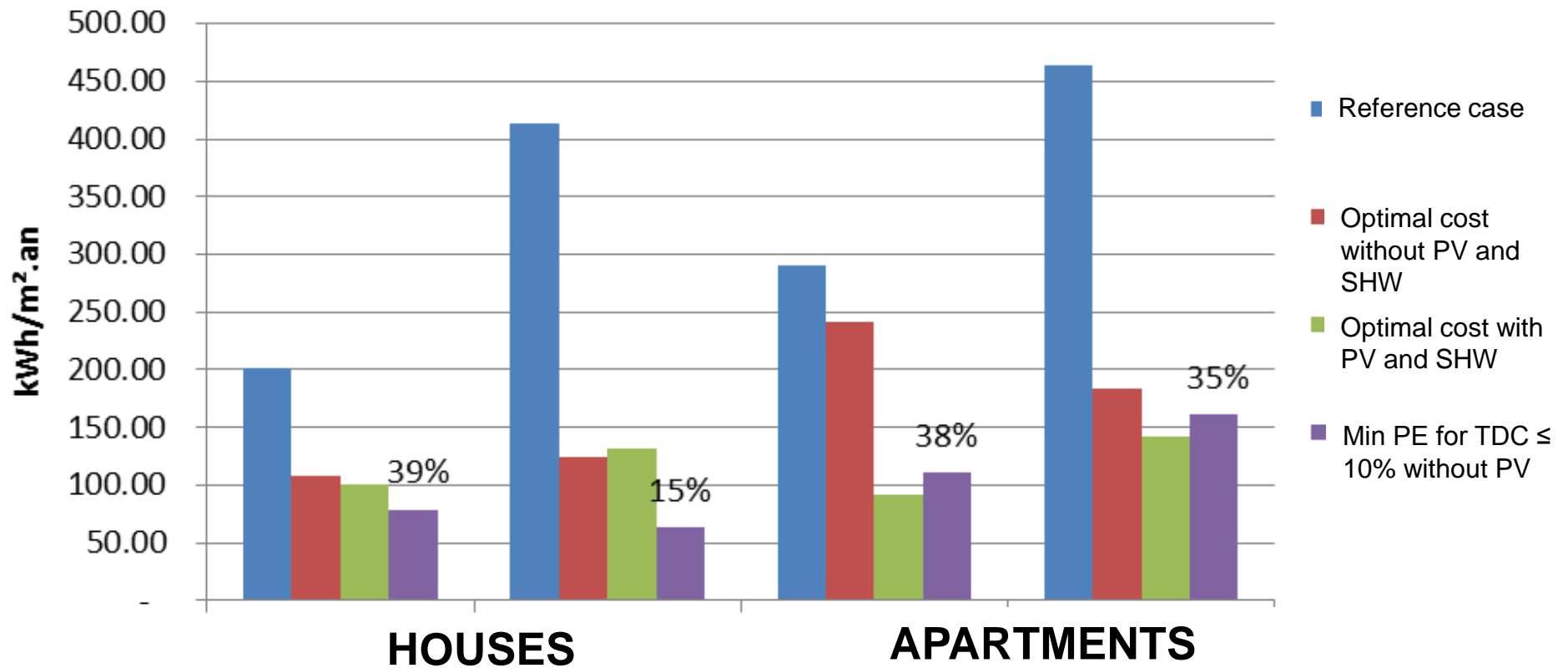

PV = Photovoltaic
SHW = Sanitary Hot Water

PE = Primary Energy
TDC = Total Discounted Cost

BRUSSELS POLICY FOR HIGH ENERGY PERFORMANCE BUILDINGS



Brussels objective : -30% GHG in 2025

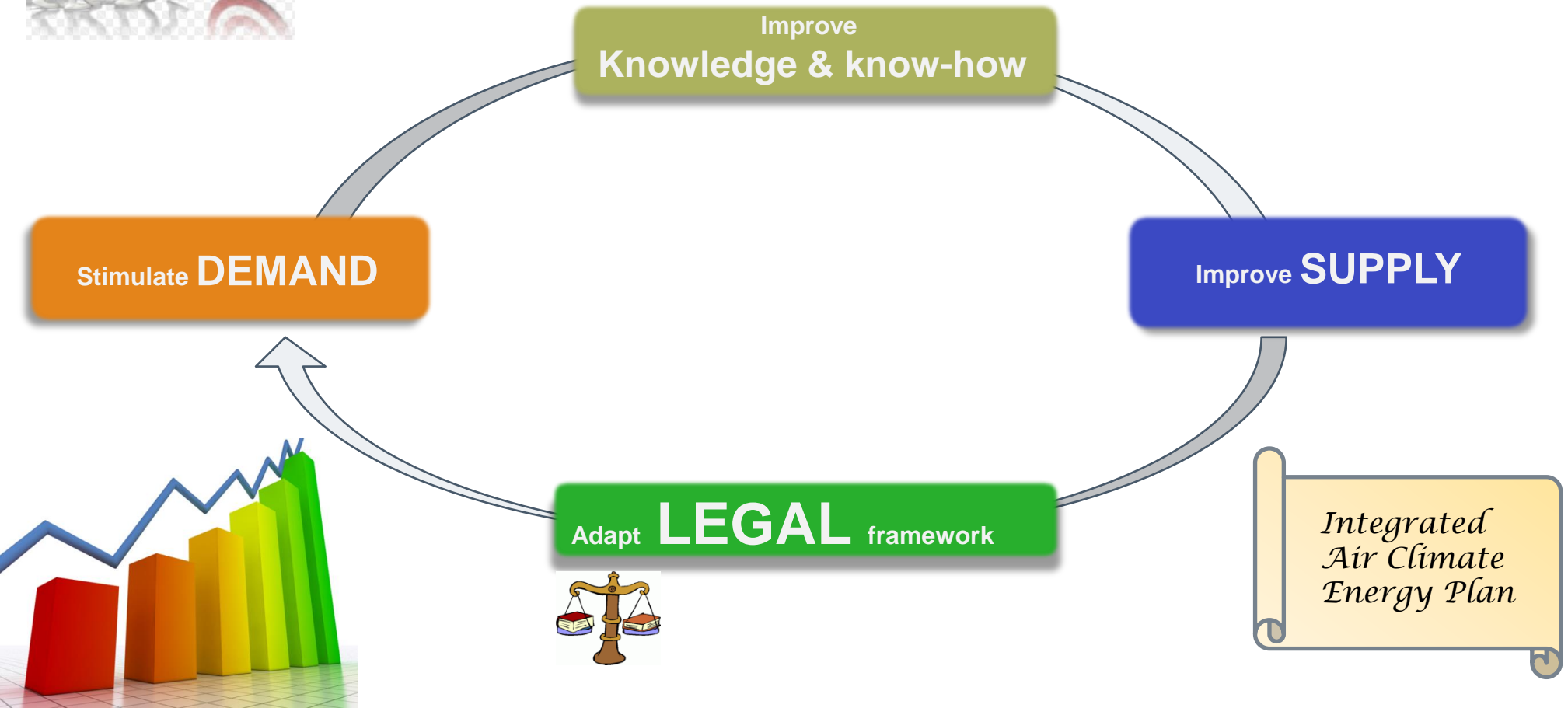

BRUSSELS POLICY

Stimulate
DEMAND

RK02559-0151
Sensibilisation and advice

Financial instruments



*Occupancy
Cost*

Exemplarity

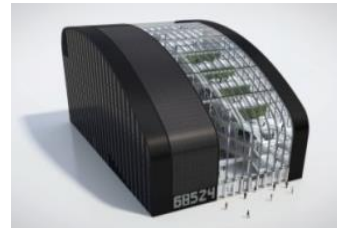

Commitment of public authorities

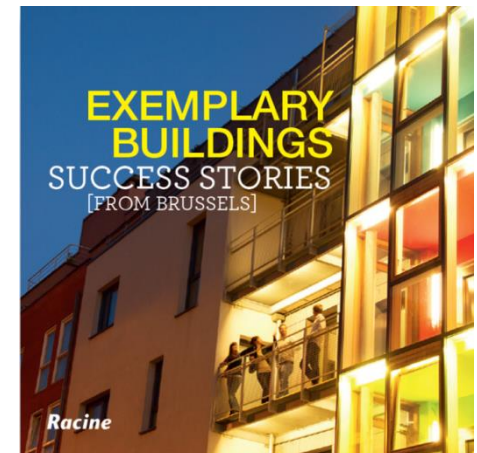

BRUSSELS POLICY

Improve
**Knowledge &
know-how**

Sustainable building certification system

Sustainable building trainings



Sustainable building guide



Reference Construction Center



BRUSSELS POLICY

Improve SUPPLY

Incubator

Brussels Greenbizz, incubateur vert à Laeken

← Accueil
d'entreprises



Rue de Molenbeek,
198
Laeken

2013-06-07 - Le site de Brussels Greenbizz s'étale sur un îlot de
160 x 60 mètres, **tout près du canal**. Sur le territoire de

Cluster Ecobuild



impulse.brussels 
never stop asking



BRUSSELS POLICY

Adapt **LEGAL**
framework

BRUSSELS POLICY

COBRACE ↔ **AIR CLIMAT ENERGY PLAN**

A single legislation, a single vision, a single plan

Merge several environmental regulations & transposes new directives



Local Plan for Energy Management



CONCLUSIONS

CONCLUSION

- * The Brussels-Capital Region has paved the way for greater restraint in energy use without compromising its economic viability
- * The COBRACE and the Air-Climate-Energy Plan are existing tools contributing to the refurbishment strategy
- * Reflection is still running on how to improve the refurbishment rate in RBC



THANK YOU FOR YOUR ATTENTION !

Aurore BRUNSON

abrunson@environnement.irisnet.be

DEPT. OF AIR, ENERGY AND CLIMATE, ENERGY PLANNING